



CONSUMER PRODUCTS SERVICES DIVISION

**Plicosa International Taiwan Ltd**

**Technical Report:** (6619)305-0589  
**Date Received:** NOV.01, 2019  
**Mod. Date:** /

NOV.14, 2019  
Page 1 of 10

Andy/Tracy/Isaac  
Plicosa International Taiwan Ltd  
3F, No.39, Lane513, Ruiguang Rd., Neihu, Taipei, Taiwan

Sample Description:	STEEL TEXTILE LOUNGER		
Manufacturer:	ZHEJIANG LINYA CO.,LTD.	PO No.:	/
Buyer:	/	Style No	TGLST0059(LLCT9299)
Country of Origin:	CHINA	Country of Destination:	/
Color:	/	SKU No.:	/
Protocol No.:	/	Previous Report No.:	/

**TEST INFORMATION & EXECUTIVE SUMMARY**

**Evaluation To:** For compliance with: -

1. EN 581-1: 2017, Outdoor furniture – seating and tables for camping, domestic and contract use – Part 1: general safety requirement.
2. EN 581-2: 2015 + AC: 2016 – Outdoor furniture – Seating and tables for camping, domestic and contract use – Part 2: mechanical safety requirements and test methods for seating. (Test level: domestic level)

**Standards Employed:** As specified in above standard(s)

1. EN 1022: 2005, Domestic furniture – seating – determination of stability
2. EN 1728: 2012+AC:2013, Domestic furniture – seating – test methods for the determination of strength and durability

**Conclusions:**

1. The tested sample COMPLIED with the above standard: EN 581-1: 2017
2. The tested sample COMPLIED with the above standard: EN 581-2: 2015 + AC: 2016 (Test level: domestic level)

**REMARK:**

The client specifies the test methods and requirements.

Bureau Veritas  
Consumer Products Services (Shanghai)  
No. 168, Guanghua Road, Zhuangqiao Town,  
Minhang, Shanghai, China.  
Post Code:201108  
Tel: 86-21-24166888 Fax: 86-21-64891984  
Http : www.cps.bureauveritas.com

This report is governed by, and incorporates by reference, CPS Conditions of Service as posted at the date of issuance of this report at <http://www.bureauveritas.com/home/about-us/our-business/cps/about-us/terms-conditions/> and is intended for your exclusive use. Any copying or replication of this report to or for any other person or entity, or use of our name or trademark, is permitted only with our prior written permission. This report sets forth our findings solely with respect to the test samples identified herein. The results set forth in this report are not indicative or representative of the quality or characteristics of the lot from which a test sample was taken or any similar or identical product unless specifically and expressly noted. Our report includes all of the tests requested by you and the results thereof based upon the information that you provided to us. Measurement uncertainty is only provided upon request for accredited tests. You have 60 days from date of issuance of this report to notify us of any material error or omission caused by our negligence or if you require measurement uncertainty; provided, however, that such notice shall be in writing and shall specifically address the issue you wish to raise. A failure to raise such issue within the prescribed time shall constitute your unqualified acceptance of the completeness of this report, the tests conducted and the correctness of the report contents.



**BVCPS (SHANGHAI) GENERAL CONTACT INFORMATION FOR THIS REPORT**

TELEPHONE NO 86-21-24166888  
E-MAIL: [bvcpshtoy.sh@cn.bureauveritas.com](mailto:bvcpshtoy.sh@cn.bureauveritas.com)

**BUREAU VERITAS**  
**CONSUMER PRODUCTS SERVICE DIVISION (SHANGHAI)**  
Laboratory Test location:  
No. 368, Guangzhong Road, Zhuanqiao Town, Minhang,  
Shanghai.  
No. 168, Guanghua Road, Zhuanqiao Town, Minhang, Shanghai.

Hyde Bao  
PRODUCT LINE MANAGER(HARDLINE DIVISION)

## SUMMARY OF EXAMINATION

### Introduction:

An examination was requested to ascertain compliance with the requirement(s) as detailed on page one of this report. The following clauses were considered applicable and our findings were as follows:

<b>EN 581-2: 2015+AC:2016 (Test Level: domestic level)</b>			
Clause	Description	Result	*Comments
4 & EN 1728:2012+AC:2013,4.1	Preliminary preparation	CONDUCTED	See note I
--	Defect observed before testing	--	See note II
EN 581-1:2017	General safety requirements	PASS	See note III
EN 581-2:2015+AC:2016 A.1.1	Sideway stability test	PASS	--
EN 1022:2005,6.6	Rearward stability test	PASS	--
EN 1022:2005,7.5	Rearward stability test	PASS	--
EN 581-2:2015+AC:2016 A.1.2	Forward stability test	PASS	--
EN 1728:2012+AC:2013,8.2	Seat & back static load	PASS	--
EN 1728:2012+AC:2013,8.3	Additional seat and leg rest static load test	PASS	--
EN 1728:2012+AC:2013,8.4.1	Seat and back fatigue test	PASS	--
EN 1728:2012+AC:2013,8.4.2	Additional seat durability test	PASS	--
EN 1728:2012+AC:2013,8.5	Durability test on back rest mechanism	NA	See note IV
EN 1728:2012+AC:2013,8.6	Arm downwards static load test	NA	See note IV
EN 1728:2012+AC:2013,8.7	Arm fatigue test	NA	See note IV
EN 1728:2012+AC:2013,8.8	Impact test	PASS	--
EN 1728:2012+AC:2013,8.9	Lifting test	NA	See note IV
EN 581-2:2015+AC:2016 A.1.1	Sideway stability test	PASS	--
EN 1022:2005,6.6	Rearward stability test	PASS	--
EN 1022:2005,7.5	Rearward stability test	PASS	--
EN 581-2:2015+AC:2016 A.1.2	Forward stability test	PASS	--
8.1	Instruction for use	PASS	--

## ANNEX I: SUBMISSION DESCRIPTION

Sample Description: STEEL TEXTILENE LOUNGER

The overall dimension was recorded as:  
(200.0~164.3) cm (D) x 61.0cm (W) x (32.7~92.0) cm (H)

Sample weight: 12.1kg

## ANNEX II: ADDITIONAL COMMENTS

- I Samples were stored in indoor ambient condition 24 hours immediately prior to testing.
- II No defect was observed before testing.
- III Reference to detail test results of EN 581-1: 2017

EN 581-1: 2017			
Clause	Description	Result	*Comments
5.1	General	PASS	--
5.2	Tubular components	PASS	--
5.3	Shear and squeeze points	--	--
5.3.1	Shear and squeeze points when erecting, adjusting and folding away	PASS	--
5.3.2	Shear and squeeze points under the influence of powered mechanisms	NA	See note IV
5.3.3	Shear and squeeze points during use	PASS	--

- IV NA = Not applicable
- V NC = Not conducted as per client request

**EXHIBIT**



## INSTRUCTION

### IMPORTANT, RETAIN FOR FUTURE REFERENCE: READ CAREFULLY

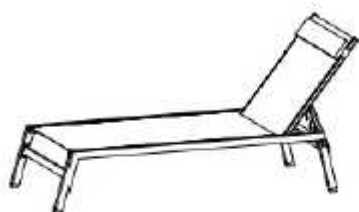

Only for domestic use.

#### Maintenance

- Clean with a soft cloth.
- Remove dust regularly with the help of a soft and clear water.
- Do not use abrasive cleaners or detergents for cleaning.

#### Storage conditions

- After each use, keep the product dry and protected from the elements.
- Do not keep wet.
- This lounge must be stored in a dry place.

#### SUPPLIER

PLICOSA INTERNATIONAL TAIWAN LTD  
3/F, N°39 Lane 513, Ruiguang Road, Neihu, Taipei, TAIWAN ROC

**IMPORTANTE – CONSERVE ESTA INFORMACIÓN PARA SU  
CONSULTA POSTERIOR : LEER DETALLADAMENTE**

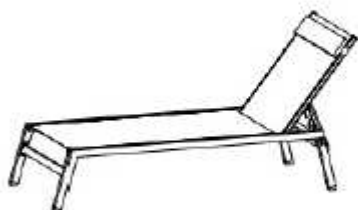

**Solamente para Uso Doméstico.**

**Mantenimiento**

- Limpiar con la ayuda de un trapo suavemente.
- Retirar el polvo regularmente con la ayuda de un paso suave y de agua clara.
- No utilizar detergentes o productos abrasivos para su limpieza.

**Condiciones de almacenaje**

- Después de cada utilización guarde el producto seco y en al resguardo de la intemperie.
- No guardar nunca húmedo.
- Esta tumbona debe almacenarse en un lugar seco.

**PROVEEDOR**

PLICOSA INTERNATIONAL TAIWAN LTD  
3/F, N°39 Lane 513, Ruiguang Road, Neihsu, Taipei, TAIWAN ROC

**IMPORTANTE – CONSERVE ESTA INFORMAÇÃO PARA UMA  
CONSULTA POSTERIOR : LER COM ATENÇÃO**

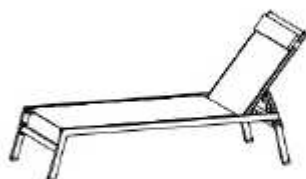

**Apenas para uso doméstico.**

**Manutenção**

- Limpar com um pano humido suave.
- Retirar o pó regularmente com ajuda de um pano suave e de água limpa.
- Não utilizar detergentes ou produtos abrasivos.

**Condições de armazenamento**

- Depois de cada utilização guardar e limpar ao abrigo das intempéries.
- Nunca guardar a mesa molhada.
- Esta espreguiçadeira deve ser armazenada em local seco.

**FORNECEDOR**

Plicosa International Taiwan Ltd  
3F, No.39, Lane 513, Ruiguang Rd., Neihu, Taipei, Taiwan, R.O.C.



**IMPORTANT - À CONSERVER POUR CONSULTATION  
ULTÉRIEURE : À LIRE ATTENTIVEMENT**

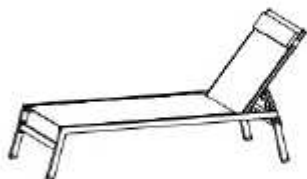

**Usage Domestique uniquement**

**Entretien**

- Laver à l'eau et au savon.
- Procéder au dépoussiérage régulier de l'article à l'aide d'un chiffon doux et de l'eau claire.
- Ne pas utiliser de détergents ou de produits abrasifs pour le nettoyage.

**Conditions de stockage**

- Après chaque utilisation rentrer votre produit au sec et à l'intérieur.
  - Ne pas ranger humide.
  - Cette bain de soleil doit être stockée dans un endroit sec.
- Cette chaise longue doit être rangée dans un endroit sec

**Fournisseur**

Plicosa International Taiwan Ltd  
3F, No.39, Lane 513, Ruiguang Rd., Neihu, Taipei, Taiwan, R.O.C.

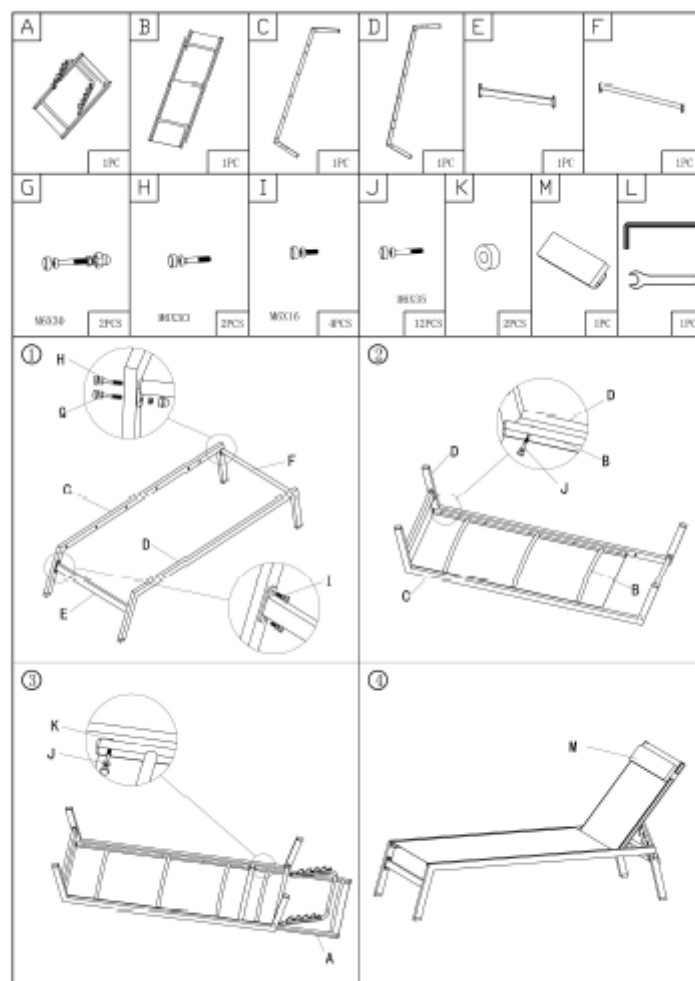

END